

The Pro

The Assistive Listening Device
by Conversor Limited

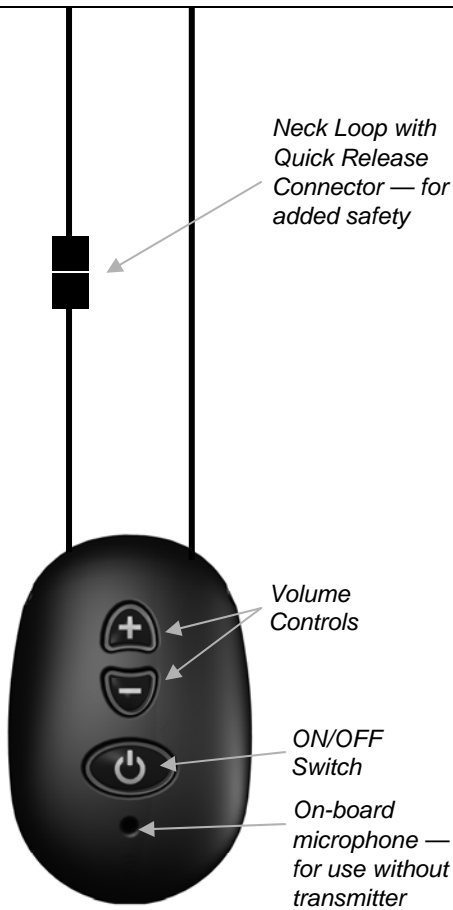

The Pro Receiver

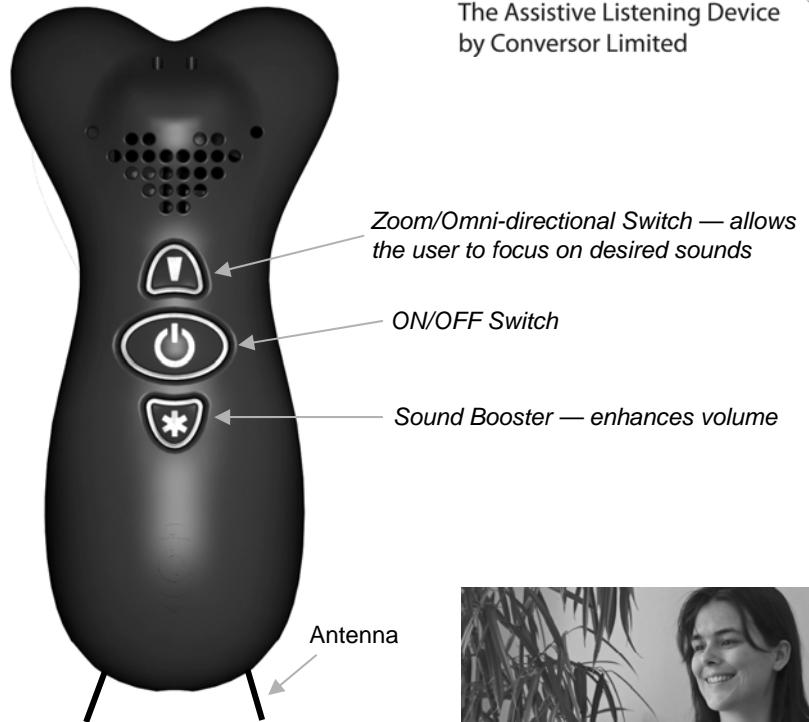

The Pro Transmitter



Easy, everyday use

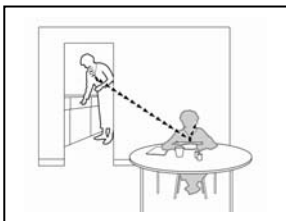

Between Rooms

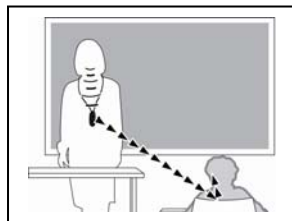

In the Classroom

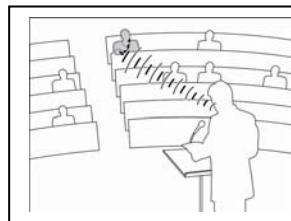

In the Lecture Theatre

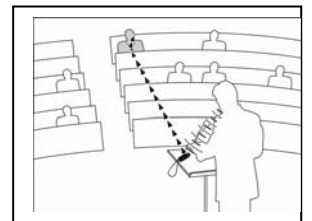

Worn by the Speaker

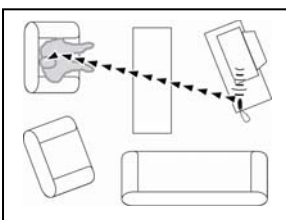

Watching Television

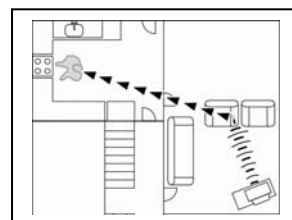

In a Different Room

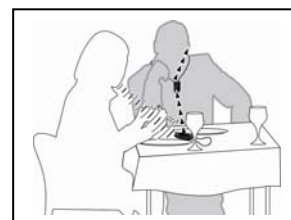

In a Café/Restaurant

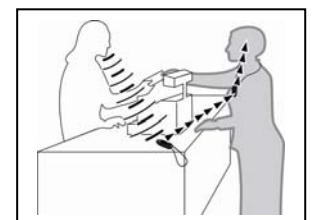

Out Shopping

For more information, please contact:



1/10 Dorsey Street, Milton, QLD 4064
PO Box 1869, Toowong DC, QLD 4066
Free call: 1800 639 263 F 07 3368 1044
E enquiry@sonici.com.au W www.sonici.com.au

The Pro Technical Specifications

The Pro Microphone

| | |
|--------------------------|--|
| Housing: | Plastic. Matt black finish. |
| Dimensions: | 10.2cm (L) x 3.3cm (W) x 2.3cm (D) |
| Weight: | 67 g. |
| VHF Frequencies: | ETSI Licence Exempt Channels between 169 - 175 MHz |
| Channel Selection: | PLL Synthesizer |
| Battery Type: | Rechargeable Li-Ion single cell |
| Charge life: | 8 hours approx. Red LED battery warning |
| Charge Time: | 2hrs from full discharge can be topped up |
| RF Power and Range: | <10mW Outside; up to 50m. Inside; up to 20m typical |
| Mic muting: | Mic muted when line input is connected |
| Modulation: | FM |
| Maximum Deviation: | +/- 15 kHz |
| Spurious Emission: | Below maximum ETSI permitted limits |
| Frequency Stability: | < +/-5kHz (0-40 degrees Celsius) |
| Frequency Response: | +/- 3dB between 300Hz – 4kHz with resistive load |
| Microphone: | Switchable omni / unidirectional Electret microphones |
| Omni Field: | Sensitive to all directions |
| Front to Back Ratio: | Up to 30dB reduction of rearward sound @ 1kHz And up to 15dB reduction to the sides |
| Line Input Sensitivity: | 100mV RMS @ 10kohms, stereo mini-jack |
| Sensitivity: | Soft-limited, two threshold levels for both line and microphone inputs. |
| Battery Indicator Light: | Light changes from green to red, indicating 25% battery capacity remaining |

The Pro Receiver

| | |
|-------------------------------|---|
| Housing: | Plastic. Matt black finish. |
| Dimensions: | 6.5cm (L) x 3.4cm (W) x 1.7cm (D) |
| Weight: | 61 g. |
| VHF Frequencies: | ETSI Licence Exempt Channels between 169 - 175 MHz |
| Channel Selection: | PLL Synthesizer. Pro auto-tune (PRAT™) for class selection in school application |
| Squelch: | PSSS™ circuitry switches off audio and switches on local microphone when there is no transmission |
| Receive Indicator: | LED indication of received signal |
| Battery Type: | Rechargeable Li-Ion cell |
| Charge life: | 8 hours approx operation. LED changes from green to red as capacity drops to 25% |
| Charge Time: | 2hrs from full discharge, can be topped up, can be used for 1 hr after a 15min charge. |
| Frequency Stability: | < +/-5kHz (0-40 degrees Celsius) |
| Frequency Response: | +/- 3dB between 300Hz – 4kHz with resistive load |
| Audio Output: | 3.5mm 3-pole (stereo) jack socket |
| Distortion | <5% at max volume (typical <1%) |
| S/N ratio | > 50dB |
| Load Impedance: | 32 Ohms |
| Integral Inductive Loop: | Inductive field meets Bs 6083 Part 4 in appropriate mode |
| Acoustic Gain of Full System: | Up to 55dB |